



S M GROUP

TO BUILD A
STRONGER NATION
OF OUR DREAMS



GOVVINDA



Hamesha Aapke Saath

GOVVINDA

550SD



GOVVINDA

550SD





S M GROUP



VISION

TO BUILDING A STRONGER NATION OF OUR DREAMS

We aspire to be a premium global business agglomerate, persistently setting new benchmarks and achieving new heights in the Iron & Steel Industry.

MISSION

We aim to achieve business distinction in Iron & Steel industry by being a customer-driven, quality-enthusiast and socially responsible corporate entity.



Mr. Manish Khemmka
Chairman cum Managing Director

FROM THE CHAIRMAN'S DESK

S.M. Group's journey over these years has been a story of pioneering innovation, engineering excellence and strategic evolution as we expanded our footprints nationally and internationally and diversified our products and services portfolio. We are future-ready organisation which is ready to adapt change, providing a holistic working environment for our employees. We will continue to support India in its journey towards '**Aatmanirbhar Bharat**' .

As **S.M. Group** embarks into a new exciting journey of TMT production; our goal is to be the first choice when one thinks of steel and emerge as one of the top steel manufacturer in India and to be responsible value creators for India. Our vision is to be globally significant, while maintaining high-quality standard of products at the same time.

ABOUT **US**

S.M. Group is one of the Leading Exporter, Importer of Industrial & Commercial products and Steel manufacturer today, with its corporate office at Kolkata (West Bengal), and plant located at Jamshedpur (Jharkhand). Starting with Exports and it's Core Competency business in Mining, it has now diversified into various areas. Expanding from its existing set up, the Group came up with its own DRI Unit, SMS Unit, Continuous Billet Casting Mill, testing laboratories with modern technology & Fully Automated Rolling Mill Powered by its in-house Captive Power Plant which runs with rejected coal and waste heat from DRI hence minimizing the carbon footprint and ensuring uninterrupted power supply for production. It has received ISO - 9001, 14001 and OHSAS 18001 certification.

Today, S.M. Group, under its umbrella has companies which are into business of Iron Ore Pellets, Coal, Sponge Iron, Sponge Iron Pellets, Coke, MS Billets, TMT Rebars. S.M. Group had already reached annual turnover of INR 4500 Crores (Approx.) and has established itself as one of the fastest growing group.



INTEGRATED STEEL PLANT (ISP)

Its integrated steel plant has DRI Unit, SMS Unit, Continuous Billet Casting Mill, fully automated Rolling Mill and fully-equipped with modern Testing laboratories. It has received ISO - 9001, ISO - 14001 and OHSAS 18001 certification. Our Plant has an exhaustive production process in compliance with the international standards, which precisely involves the following stages:



- *Raw materials are treated at the DRI (Direct Reduced Iron) plant.*
- *High quality billets are obtained from the steel melting shop.*
- *Billets are passed through the state-of-the-art rolling mill.*
- *Self-Tempering process is used to result in a structure called 'Tempered Martensite'.*
- *Atmospheric Cooling process comes into play where heat of the core area tempers the Martensite part and the ductile core becomes the Ferrite Pearlite structure.*
- *Mechanical & chemical tests are done at par with IS 1786:2008.*
- *TMT Bars are cut into required length, bundled up and tagged.*

This pioneer TMT bar manufacturing company caters its products to government agencies, industry houses, civil contractors and real estate developers.

*They are ideal for building houses, flyovers, dams, bridges and other critical structures where high yield load is required without compromising on the quality. **GOVVINDA TMT** is committed to provide complete customer satisfaction with respect to quality, delivery and services. Feedback from the customers acts as inputs for continuous improvement on products and services.*

CORE BUSINESS



IRON ORE

We offer our client Iron Ore Lumps which are available in various textures, sizes, flamed and finishes. It can be personalized as per the requirement of our customers. The complete batch of ores are tested on a variety of parameters to ensure that they comply with client's specifications.



COAL ORE

We offer our client Iron Ore Lumps which are available in various textures, sizes, flamed and finishes. It can be personalized as per the requirement of our customers. The complete batch of ores are tested on a variety of parameters to ensure that they comply with client's specifications.



SPONGE IRON

We offer our client Iron Ore Lumps which are available in various textures, sizes, flamed and finishes. It can be personalized as per the requirement of our customers. The complete batch of ores are tested on a variety of parameters to ensure that they comply with client's specifications.



MANGANESE ORE

We offer our client Iron Ore Lumps which are available in various textures, sizes, flamed and finishes. It can be personalized as per the requirement of our customers. The complete batch of ores are tested on a variety of parameters to ensure that they comply with client's specifications.



COPPER ORE

We offer our client Iron Ore Lumps which are available in various textures, sizes, flamed and finishes. It can be personalized as per the requirement of our customers. The complete batch of ores are tested on a variety of parameters to ensure that they comply with client's specifications.

PRODUCT RANGE



MS BILLETS

We offer our client Iron Ore Lumps which are available in various textures, sizes, flamed and finishes. It can be personalized as per the requirement of our customers. The complete batch of ores are tested on a variety of parameters to ensure that they comply with client's specifications.



TMT REBARS

We offer our client Iron Ore Lumps which are available in various textures, sizes, flamed and finishes. It can be personalized as per the requirement of our customers. The complete batch of ores are tested on a variety of parameters to ensure that they comply with client's specifications.

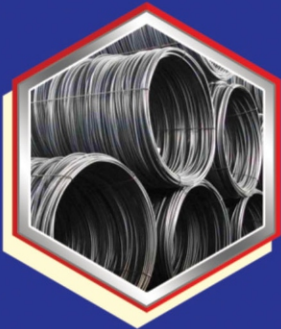

WIRE ROD

We offer our client Iron Ore Lumps which are available in various textures, sizes, flamed and finishes. It can be personalized as per the requirement of our customers. The complete batch of ores are tested on a variety of parameters to ensure that they comply with client's specifications.



WIRE ROD & BINDING WIRE

We offer our client Iron Ore Lumps which are available in various textures, sizes, flamed and finishes. It can be personalized as per the requirement of our customers. The complete batch of ores are tested on a variety of parameters to ensure that they comply with client's specifications.

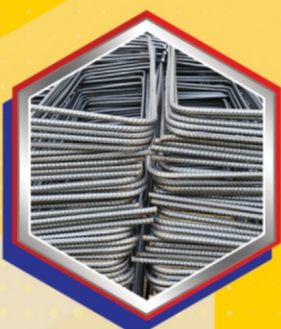

GO-RINGS

We offer our client Iron Ore Lumps which are available in various textures, sizes, flamed and finishes. It can be personalized as per the requirement of our customers. The complete batch of ores are tested on a variety of parameters to ensure that they comply with client's specifications.

Making of GOVINDA TMT REBAR

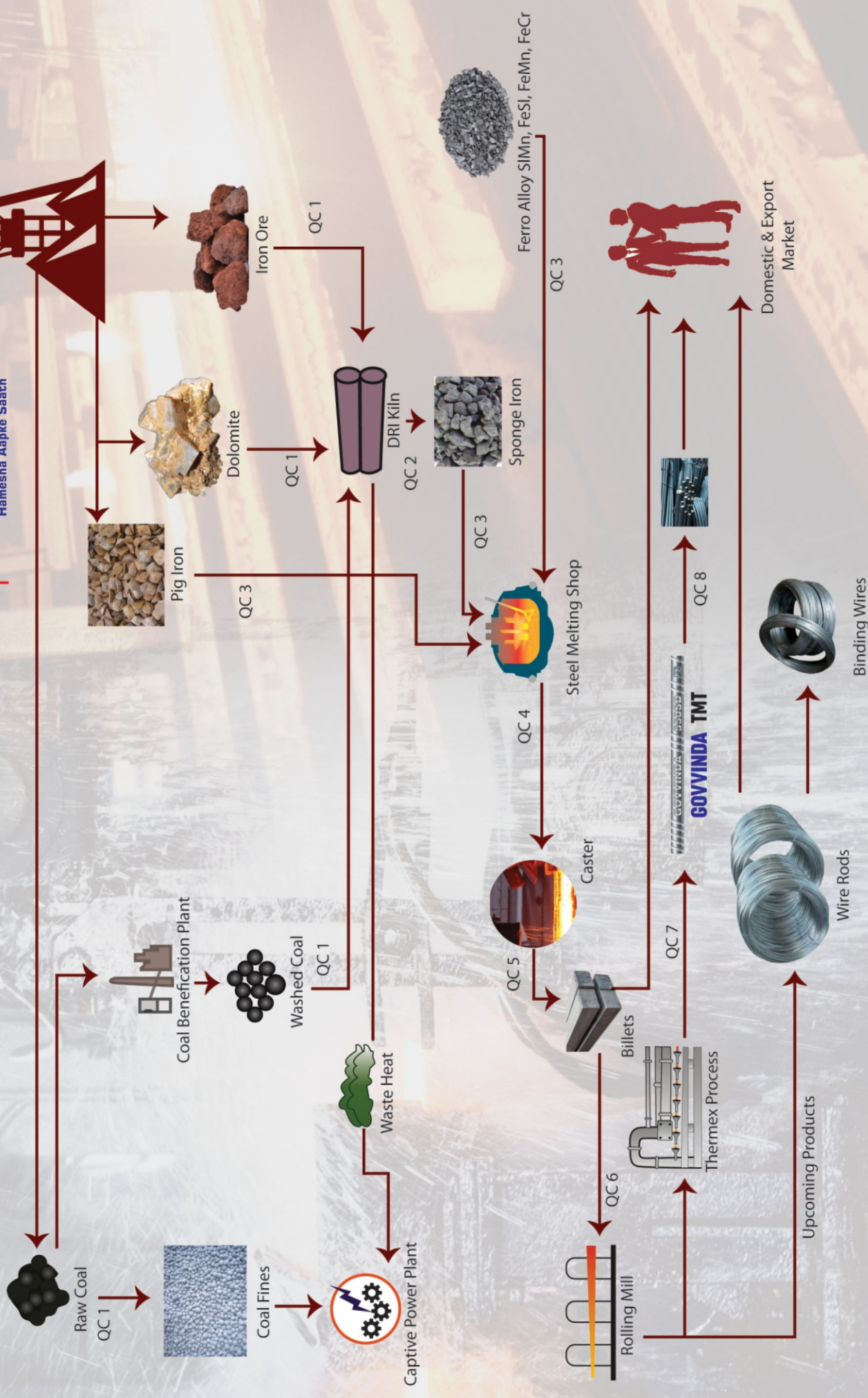

TECHNICAL SPECIFICATION

AS PER INDIAN STANDARDS 1786:2008

CHEMICAL PROPERTIES COMPARISON CHART

PARAMETERS	ISI BENCHMARK			GOVINDA TMT	
	Fe 500D	Fe 500S	Fe 550D	Fe 500D	Fe 550SD
Grade	Fe 500D	Fe 500S	Fe 550D	Fe 500D	Fe 550SD
Carbon	0.25	0.25	0.25	0.18	0.20
Sulphur	0.040	0.040	0.040	0.040	0.040
Phosphorus	0.040	0.040	0.040	0.040	0.040
S + P	0.075	0.075	0.075	0.075	0.075

MECHANICAL PROPERTIES COMPARISON CHART

PARAMETERS	ISI BENCHMARK		GOVINDA TMT	
	Fe 500D	Fe 550D	Fe 500D	Fe 550SD
Grade	Fe 500D	Fe 550D	Fe 500D	Fe 550SD
Yield Stress (n/mm ²)	500	550	535	560
Tensile Strength Min (n/mm ²)	565	600	590	610
Elongation % (Min)	16	14.5	16	14.5
TS/YS Ratio	1.10	1.09	1.10	1.09

OUR QUALITY ASSURANCE

The work culture at Nilachal Iron and Power Limited involves constant and timely upgradation of technology and our facilities boast of a production line that is closely monitored. Automated state-of-the-art milling machines at all our workshops ensure consistency and stringent quality assurance and also helps in rolling out bars across a range of diameters, with precision and accuracy.

Nilachal Iron and Power Limited has excellent laboratory facilities and all incoming raw materials and outgoing finished goods undergo strict quality checks. All elements are analysed using a spectrometer.



WHY GOVVINDA TMT?

GOVVINDA TMT IS A TRUSTED NAME IN STEEL INDUSTRY



ACCURATE RIB PITCH : The external ribs running across the entire length of the Govvinda TMT bar and TMT Rebar give superior bonding strength between the bar and the concrete. Perfect grip pitch ensures strongest bonding between concrete and frame.



SUPER DUCTILITY : Govvinda TMT bars provides better ductility and bendability which eliminate stressful manual binding at the site, reducing construction and fabrication time.



MASSIVE TENSILE STRENGTH : Govvinda TMT Rebar's higher ultimate tensile strength ratio ensures that when stressed beyond yield strength as may happen during an earthquake Govvinda TMT bar will absorb the stress with ease and to a much greater extent without any danger of sudden rupture.



SUPERIOR WELDABILITY : Govvinda TMT Bar is made with a controlled chemistry of carbon, sulphur, phosphorous and other alloying elements. Carbon equivalence is maintained in a lower range to facilitate good weldability.



EXCELLENT BENDABILITY : The unique combination of tempered martensite and ferrite + Partite structure assures better Bendability.



AVAILABILITY : Govvinda TMT Rebar are available in sizes ranging from 8 mm to 32 mm.



CORROSION RESISTANCE : Govvinda TMT Bar has superior strength and better anti-corrosive properties than other similar products in the market.

GOVVINDA TMT Grade:
Fe 550SD & Fe 500D





CSR Activities

At SM Group, all our Corporate Social Responsibility initiatives focus on improving the quality of life of underprivileged communities, neighbouring our business operations. Keeping up with the Sustainable Development Goals (SDGs), our interventions focus on health, education, employability and environment, with a special focus on the historically and helping some of the poorest and most disadvantaged women and girls in India, by providing education opportunities, improved health services, sustainable livelihoods and protecting and supporting communities in times of disaster.

CSR at a glance:

- *Providing free Vaccination to 5,000 people in Kolkata.*
- *Water purification to the nearby villages.*
- *Promoting Animal welfare.*
- *Promoting Art & Culture with Sri Ram JanmbhomiTeertKshetra.*
- *Contribution to PM Cares Fund.*
- *Promoting Health Care with Chief Minister Relief Fund, West Bengal Emergency Fund, Support to MCKS Trust Fund, Marwari Relief Society and Shri Vishudhanand.*
- *Promoting Education with Akhil BharatiyaVanvasi Kalyan Ashram and Purvanchal Kalyan Ashram*





9001:2015



NILACHAL IRON & POWER LIMITED

AN INTEGRATED STEEL PLANT

Corp. Office : "Godrej Waterside" Tower-1 Unit-504, 5th Floor, Sec-V,
Saltlake City, Block DP-5, Kolkata - 700091 | Telefax : +91 033 4090 3510
E-mail : marketing@nilachal.co.in | Web : www.govvindatmt.com

TOLLFREE : 1800 123 4500

550SD



GOVVINDA

550SD

